

VACU HOIST®

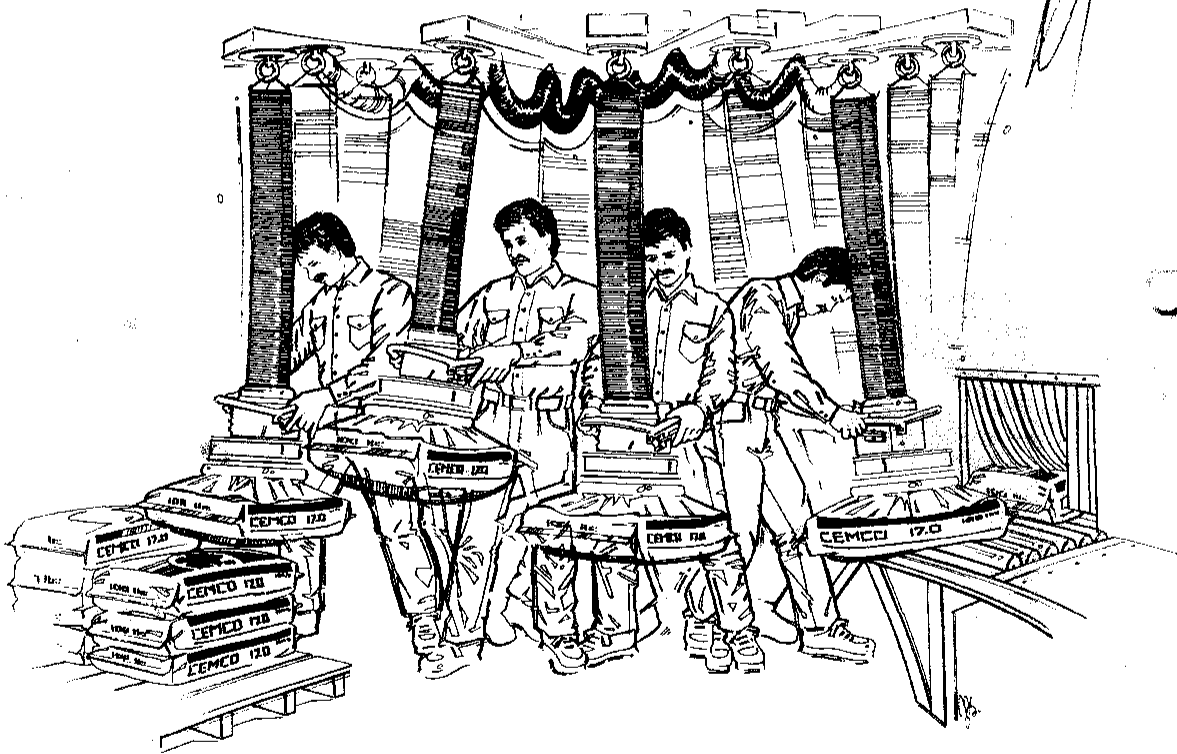

OPERATIONS MANUAL

VM SERIES

1708170

GETTING TO KNOW YOUR VACU HOIST

- A. Your Vacu Hoist unit is powered by a 4½ HP motor which requires 220 / 440V, 3 phase, AC power. The motor must be set by you for either 220 or 440V. (See diagram below)
- B. The compressor provides 207 CFM @ 16 in / Hg (or 50-55% vacuum)
- C. The minimum amperage requirement is 15. An Alan Bradley magnetic starter is recommended for simple on/off control. (running AMPS do not exceed 10 AMPS)

INSTALLATION

- A. Check that the motor is set for the proper voltage (220 or 440V 3 phase AC power). This set up is made in the terminal box on top of the motor (See diagram below).
- B. Apply power and check for proper rotational direction. If rotational direction is incorrect, reverse 2 power leads. Vacuum should be created at the small silver orifice at the top of the pump. This is the compressor intake port.
- C. Connect a short length of black 2" suction hose to the compressor intake port. Fasten with a hose clamp. Hose should be at least 3' long to allow for contraction.
- D. Connect the filter to the other end of this hose and fasten with a hose clamp. Check for proper air flow direction at filter canister (red arrow). Hose between lift tube and filter should attach to removable end of canister.
- E. Connect the remaining 2" hose between the filter and upper swivel assembly. The hose may be shortened as required. Fasten with hose clamps. (allow 1/3 add. length for contractions)
- F. Fasten the upper swivel assembly to the jib crane. Festoon (or loop) the suction tube to the crane every five feet so as to allow for contraction when lifting maximum weights at the far end of your overhead system.
- G. Be sure lift tube is set so that the suction foot is 6" from the floor.
- H. Read operating instructions before operating.

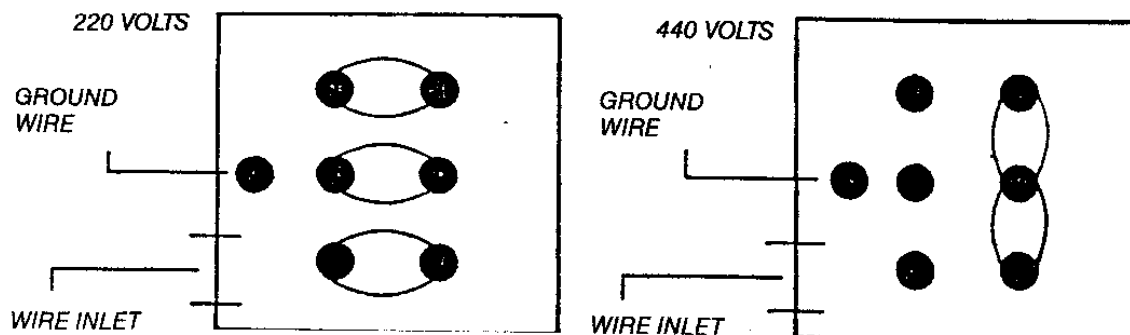

The upper swivel assembly (1), contains an attachment port for attaching the black suction hose. This consists of a 360° swivel and a safety valve, which traps the vacuum and lowers the load in the event of a power failure.

Lift tube (2) contains the vacuum. This is a special wire reinforced synthetic with a plastic finish. It is the differential air pressure created by the vacuum which raises and lowers the load.

The operating handle (3), is used by the operator to raise, lower and release the load. CAUTION: Very little movement of the operating handle is required, usually about ¼ inch up or down will raise or lower the load. To release the load, once it has been placed down, press the operating handle down fully.

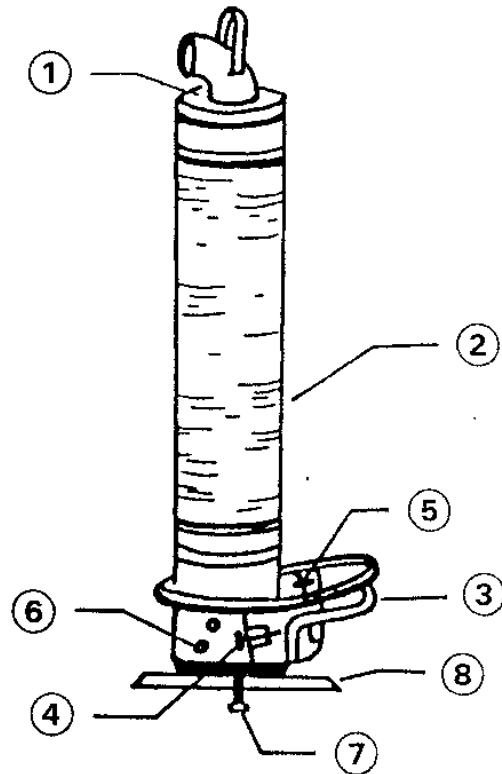

Load adjustment knob (4), this plastic knob will allow the operator to “balance” the load, i.e. to hold the load at a predetermined height without operator assistance. This height may be set at any position depending upon the operator’s preference.

Operating handle limit screw (5), will limit the upward travel of the operating handle, permitting smooth, controlled lifts.

Adjustment screw (6), will allow the operator to position the suction head and lift tube at a convenient height when not in use. This height may be set at any position in the vertical lifting range depending upon the operator’s preference.

The touch bolt (7), extends from the bottom of the suction head. When it touches the load, it opens the bottom valve, porting the vacuum to the suction foot (8), thereby gripping the load.

OPERATING INSTRUCTIONS

1. Position the lift tube directly over the load. (Lifting from any angle is dangerous).
2. Depress the control lever, the lift tube will extend lowering the suction foot to the load.
3. Establish firm contact with the load to ensure suction.
4. Raise the control lever gradually, to lift the load.
5. Adjust the "load adjusting knob" for whatever working height is desired. The load will remain at this height without operator assistance.
6. Depress the control lever slightly to lower the load.
7. To release the load, once the load is down, depress the control lever fully.

MAINTENANCE

1. Filter cartridge should be cleaned out with compressed air either on a daily, weekly, or monthly basis depending on the ambient particulate. (Dusty environments daily, dust free environments monthly.)
2. Always check gaskets on suction foot to assure proper attachment to suction foot base. Sloppy gaskets result in hazardous lifts.
3. Motor is a TEFC configuration with no maintenance required. See motor specs for details.
4. Pump is a two-stage, gas ring, oil free compressor, requiring no maintenance. See pump specs for details.
5. Damage to orange lift tube is easily repaired with duct tape.

WARRANTY

The warranty includes 100% parts, and transportation only for a period of 12 months or 2,000 operating hours, whichever comes first (excluding filters and gaskets).

LIFT TUBES

PART NO.	DESCRIPTION
16200	Lift Tube <u>Complete</u> —2.5 Meter Length Diam. 160 mm (Consisting of 10000, 10100, 16940)
16400	Lift Tube <u>Complete</u> —4.0 Meter Length
16400	Additional charge when purchased w/ a unit
16940	Lift Tube—2.5 Meter Length
16941	Lift Tube—4.0 Meter Length
16205	Lift Tube— <u>Complete</u> —2.5 Meters (Stainless Steel)
16405	Lift Tube— <u>Complete</u> —4.0 Meters (Stainless Steel)
16945	Lift Tube—2.5 Meter Length (Stainless Steel)
16946	Lift Tube—4.0 Meter Length (Stainless Steel)
16947	Protective Cover for Lift Tubes

MINI LIFT TUBES

32200	Lift Tube— <u>Complete</u> —Mini 2.5 Meters (120)
32400	Lift Tube— <u>Complete</u> —Mini 4.0 Meters (120)
32940	Lift Tube—Mini 2.5 Meter Length (120)
32941	Lift Tube—Mini 4.0 Meter Length (120)

HOSING

10910	Black Suction Hose 7.5 Meters 2" Diam.
10911	Black Suction Hose 15 Meters 2" Diam.
10912	Hosing for #10600 (2 X 260 mm)
10913	Hosing for 32200 (1 X 130 mm)
10915	Hosing for 10801 (1 X 170 mm)
10916	Hosing for Flexible Handle (1 X 380 mm)
10942	Rubber Hose—Lower 18¾" x 2⅛"
10944	Rubber Hose—Upper 4⅓" x 18¾"
36HS	Hose Clamps

MINI HOSING

30910	Black Suction Hose 7.5 Meters 1¼" Diam.
30911	Black Suction Hose 15 Meters 1¼" Diam.
30912	Gray Hose Connector
32944	Rubber Hose—Upper

FLEX HANDLES

11102	Mantle For Flex Handle Suction Head
11103	Inner Section For Flex Handle
11104	Outer Section For Flex Handle
11105	Valve Box
16250	Flexible Handle with 2.5 Meter Lift Tube
16450	Flexible Handle with 4.0 Meter Lift Tube
16250	Additional charge when purchased with a unit
16450	Additional charge when purchased with a unit

SUCTION FEET

10604	Suction Foot Complete #10600 with White Gasket
10704	Suction Foot Complete #10700 with White Gasket
10714	Suction Foot Complete #10710 with White Gasket
41360	Suction Foot with 2 Adjustable Feet #10700 (For Dlb.)
41370	Suction Foot with 2 Non-Adjustable Feet #10700 (For Dlb.)

MOTOR/PUMP & ACCES.

10930	Manometer (Vacuum Pressure Gauge)
10949	Pump Only
10950	Pump with Frame
10956	Motor Compressor Complete (Mini)
10959	Motor Only (Mini)
10966	Motor Compressor Complete (Standard)
10967	Motor Compressor Complete (575)
10969	Motor Only (Standard)
10980	Drive Belt Poly-V J8 x 220
10981	Pulley For Pump Diam. 50/20 mm
10983	Pulley For Motor Diam. 90/28 mm
80115	Muffler For Compressor
80121	Gas Shock
J-200	Drive Belt For Explosion Proof Motors

JIB CRANES

60200	(2) Meter Jib Crane (Withoug Mast) Tie Rod Suspended
60300	(3) Meter Jib Crane (Without Mast) Tie Rod Suspended
60400	(4) Meter Jib Crane (Without Mast) Tie Rod Suspended
63300	(3) Meter Mib Crane (Without Mast) For Mini Unit
60410	(4) Meter Jib Boom (Track Only)

MINI SPARE PARTS MODEL 120

30000	Top Swivel Attachment— <u>Complete</u>
30100	Suction Head— <u>Complete</u>
30102	Rubber Gasket on Metal Ring
30250	Quick Release top
30260	Quick Release bottom
30350	Bottom Swivel

MINI SPARE PARTS CONTINUED

- 30800 Angle Adaptor—90 Degree
- 30943 Clamp—Upper and Lower (120)

SPARE PARTS MODEL 160

- 10000 Top Swivel Attachment—Complete (Consisting of 1003 thru 1009)
- 10100 Suction Head—Complete (Consisting of 10101 thru 10107, 10141 thru 10143, 10151, 1015-1, 10160, 10171, thru 10173, 10180, 10191)
- 10101 Valve Box
- 10090 Mantle and Handle
- 10091 Rubber Strip
- 10102 Rubber Gasket on Metal Ring
- 10104 Adjustment Screw
- 10105 Noise Reduction Packing
- 10106 Noise Reduction Packing
- 10103 Noise and Dust Filter For Suction Foot
- 10141 Balancing Valve
- 10142 Spring—3 Springs Per Package
- 10143 Touch Bolt 70 mm, 90 mm, 130 mm
- 10151 Load Adjustment Mechanism—Complete
- 10160 Aluminum Bearing (2) Per package
- 10171 Valve—Plastic
- 10172 Spring For Secondary Valve
- 10173 Spring For Primary Valve
- 10191 Limiting Screw
- 10350 Bottom Swivel (For Suction Foot)
- 10250 Quick Release Top
- 10260 Quick Release Bottom
- 10662 Springs for #10600 Suction Foot
- 10801 Angle Adaptor—90 Degree For Standard
- 10943 Clamp—Upper and Lower (price per piece)

STAINLESS STEEL SPARE PARTS

- 10000SS Top Swivel Attachment—Complete
- 10090SS Mantle with Handle
- 10100SS Suction Head—Complete
- 10101SS Valve Box
- 10104SS Adjustment Screw
- 10141SS Balancing Valve
- 10142SS Spring—3 Springs Per Package
- 10143SS Touch Bolt
- 10151SS Load Adjustment Screw
- 10171SS Valve—Plastic
- 10172SS Spring For Secondary Valve
- 10173SS Spring For Primary Valve
- 10174SS Valve Metal
- 10180SS Operation Handle
- 10943SS Clamp—Upper and Lower

FILTERS

10921	Filter Assembly— <u>Complete</u> (Consisting of #10921 thru #10923)
10922	Filter Element For Filter #10921 and #10926
10926	Filter Assembly— <u>Complete</u> (Stainless Steel)
10927	Jumbo Filter Assembly Complete (5 Gallon)
10927	Additional Charge when purchased with a unit
10928	Jumbo Filter Element
1100	Heavy Duty Filter Assembly
1100	Additional charge when purchased with a unit
1101	Filter Element For Filter #1100
1102	Prefiltered For Filter #1100
1103	"O" Ring For #1100 Filter
10103	Noise & Dust Filter For Suction Foot

GASKETS

10102	Rubber Gasket on Metal Ring
10201	Rubber Gasket For Suction Foot #10200
10205	White Rubber Gasket For #10200
10211	Rubber Gasket For Suction Foot #10210
10215	White Rubber Gasket For #10210
10221	Rubber Gasket For Suction Foot #10220
10225	White Rubber Gasket For #10220
10301	Rubber Gasket For Suction Foot #10300
10302	White Rubber Gasket For #10300
1031	Add-On Rubber Gasket For Suction Foot #10300 (Floppy)
1031-A	Clamp for #1031 Rubber Gasket (Metal)
10401	Rubber Gasket For Suction Foot #10400
10501	Rubber Gasket For Suction Foot #10500
10601	Rubber Gasket For Suction Foot #10600
10602	White Rubber Gasket For #10600
1060-A	Pad Complete with Spring & Pin For #10600
10651	Rubber Gasket For Suction Foot #10670
10651V	White Rubber Gasket For #10670
10701	Rubber Gasket For Suction Foot #10700
10702	White Rubber Gasket For #10700
10711	Rubber Gasket For Suction Foot #10710
10712	White Rubber Gasket For Suction Foot #10710
10923	Gasket for Filter #10921

MINI GASKETS

30102	Rubber Gasket on Metal Ring
30201	Rubber Gasket For Suction Foot #30200
30301	Rubber Gasket For Suction Foot #30300
30601	Rubber Gasket For Suction Foot #30600
30602	White Rubber Gasket For Suction Foot #30600
30701	Rubber Gasket For Suction Foot #30700
30702	White Rubber Gasket For Suction Foot #30700
30711	Rubber Gasket For Suction Foot #30710

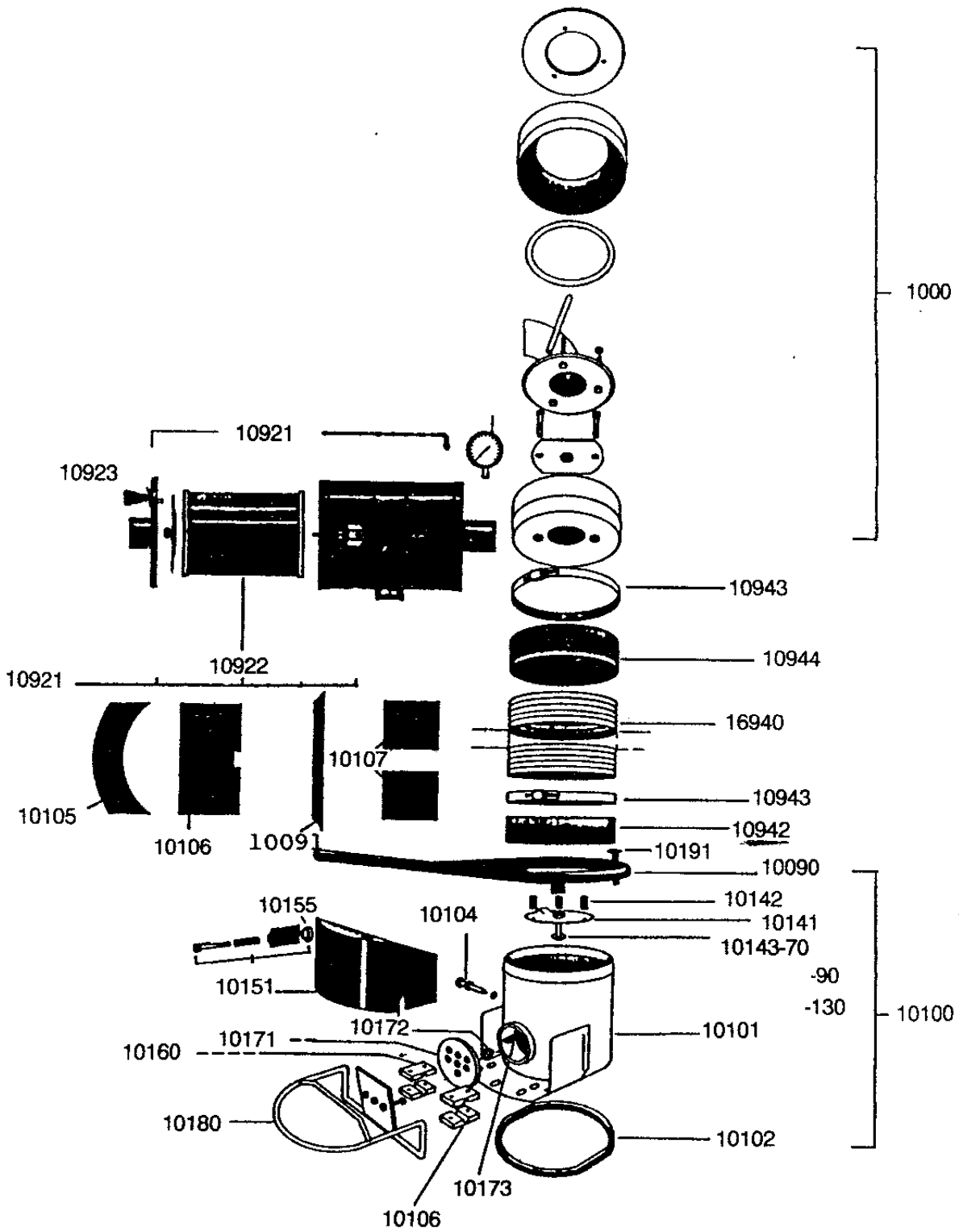

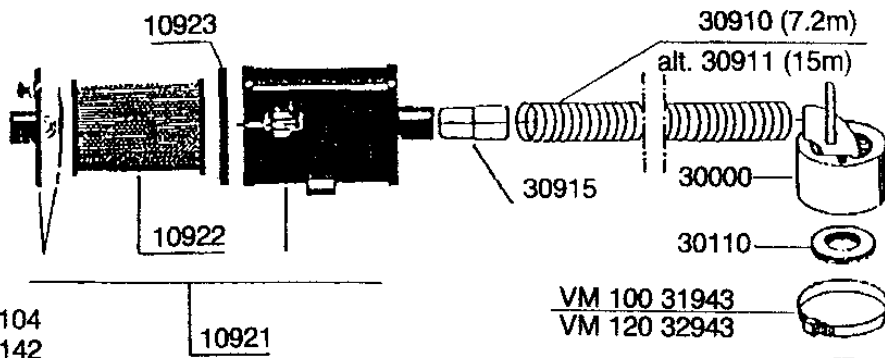

- 10104
- 10142
- 10144
- 10913
- 10921
- 10922
- 10923
- 30000
- 30101
- 30105
- 30110
- 30111
- 30112
- 30113
- 30126
- 30128
- 30140
- 30141
- 30150
- 30910/1
- 30915

- Endast VM 100
- 31940
 - 31942
 - 31943
 - 31944

- Endast VM 120
- 32109
 - 32940
 - 32942
 - 32943
 - 32944

- VM 100 31943
- VM 120 32943
- VM 100 31944
- VM 120 32944
- VM 120 32109
- VM 100 31940
- VM 120 32940
- VM 120 32109
- VM 100 31942
- VM 120 32942
- VM 100 31943
- VM 120 32943

